

Squash<sup>TM</sup>  
WATER  
GRAPHIC DESIGN  
BY CHUKWUDI PATRICK ENUMAH

GRAPHIC DESIGN



Squash™  
WATER  
GRAPHIC DESIGN



BERRY FLAVOUR IN BOTTLE



TROPIC FLAVOUR IN BOTTLE

GRAPHIC DESIGN PLAN FOR SQUASH INFUSED  
WATER ILLUSTRATED IN 2D DRAWING

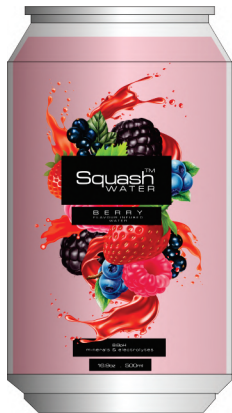

BERRY FLAVOUR IN CAN

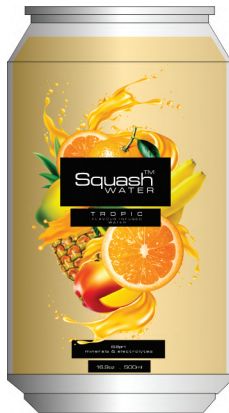

TROPIC FLAVOUR IN CAN

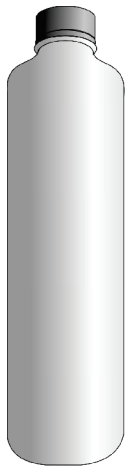

•..... Symmetrical and simple design

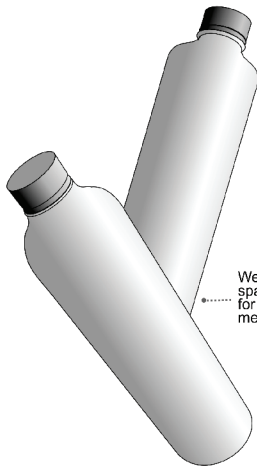

•..... Well defined space on the bottle for engaging marketing message

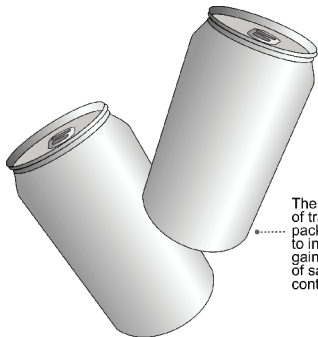

The reason for the use of transparent can in the packaging of the product is to increase product visibility, gain instant trust at the point of sale and to showcase product content quality

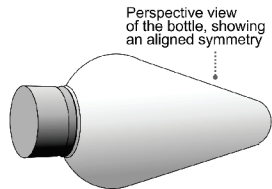

Perspective view of the bottle, showing an aligned symmetry

Squash<sup>TM</sup>  
WATER  
GRAPHIC DESIGN